

PROJECT MANAGER: PAUL M. REPASKY  
 P:\MUL2001\01\G\CADD-DATA\DWG\CSP-BASE.DWG - C-2 - FULL SCALE MONOCHROME.STB - PLOTTED 10/25/2011 2:46 PM BY REPASKY, PAUL

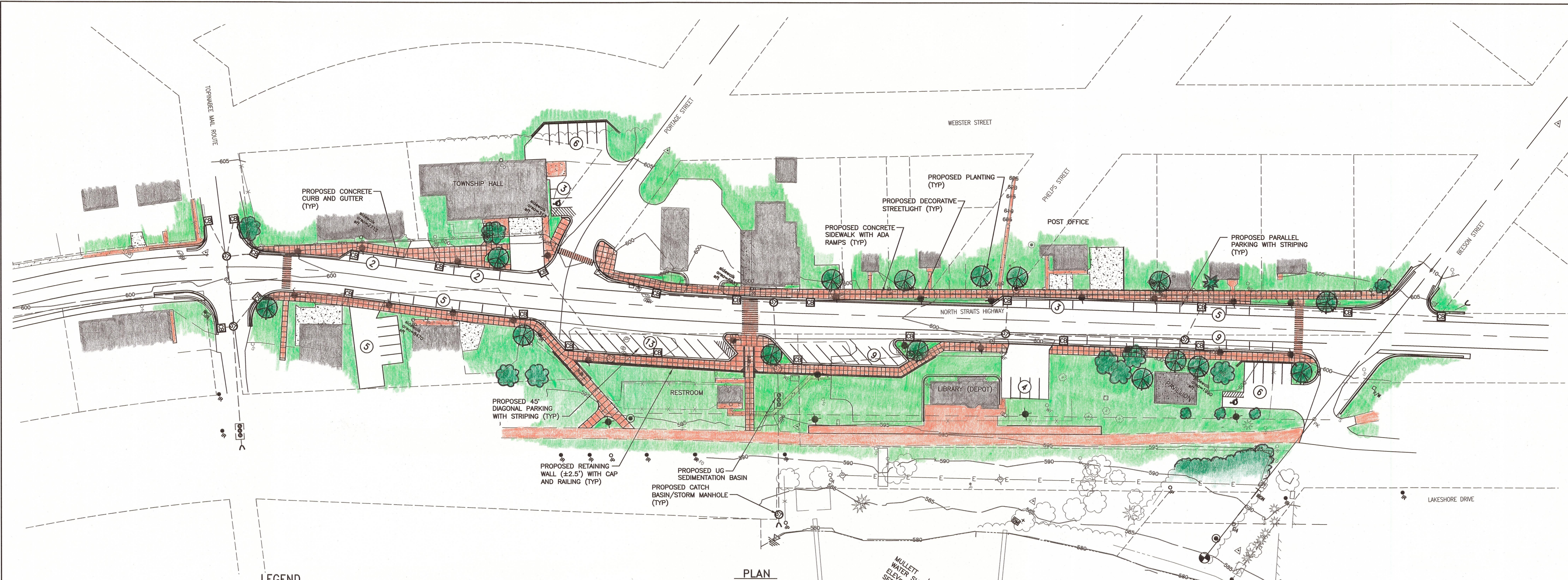

PLAN  
 MULLETT LAKE WATER SURFACE  
 ELEV = 579.6'  
 SEPT. 23, 2011

LEGEND	
EXISTING	PROPOSED
MAJOR CONTOUR	865
MINOR CONTOUR	866
FENCE	X X X
RIGHT-OF-WAY LINE	---
EASEMENT	---
SECTION CORNER	+
STORM SEWER MAIN	STM
STORM MANHOLE / CATCH BASIN	⊕ ⊕
UTILITY MANHOLE / VALVE VAULT	⊙ ⊙
BUILDING LINE	////
GAS LINE	G G G
ELECTRIC	E E E
FIBER OPTIC TELEPHONE	UT UT UT
BENCHMARK	BM
PROPERTY CORNER (AS NOTED)	●
POWER POLE	⊙
GUY ANCHOR	⊙
GUY POLE	⊙
ELECTRIC HAND HOLE	⊙
UNDERGROUND UTILITY MARKER	⊙
LIGHT POLE	⊙
MAILBOX	⊙
SIGN POST	⊙

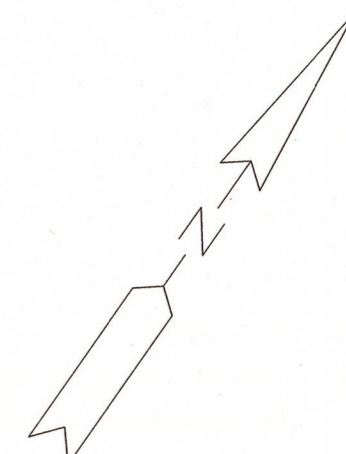
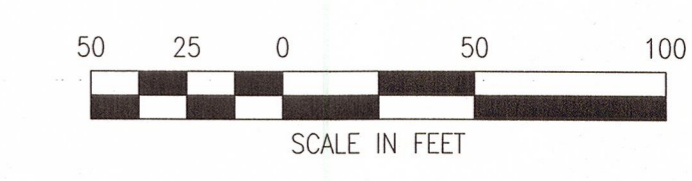

REV	DATE	DESCRIPTION	BY

NOT VALID FOR CONSTRUCTION UNLESS SIGNED AND DATED:  
 SEE COVER SHEET FOR SIGNATURES

**WADE TRIM**  
 271 West McCoy Road, P.O. Box 618  
 9887 732.354.900 988.4440  
 FAX: 988.732.8391  
 www.wadetrtrim.com

Building relationships on a foundation of excellence

**MULLETT LAKE TOWNSHIP**  
**1491 STRAITS HIGHWAY**  
**TOPINABEE, MI 49791**  
 OLD-27 (STRAITS HIGHWAY) STREETSCAPE PROJECT  
 VILLAGE CENTER

ISSUED FOR: Prelim	DATE: 	BY: PMR
-----------------------	-----------	------------

W-T REF. NO.  
**MUL2001-01G**  
 SHEET  
**C-2**

© Wade Trim Group, Inc. OLD-27 (STRAITS HIGHWAY) STREETSCAPE PROJECT